

# USER MANUAL



Thank you for choosing Better Bathrooms.  
Please read this manual before installing your product  
and keep for future reference.

**better**   
**bathrooms**

**Product name: Brushed Brass Modern Traditional Bath/Basin Spout - Lyla**

**Product code/s :LYBBSPOUT**

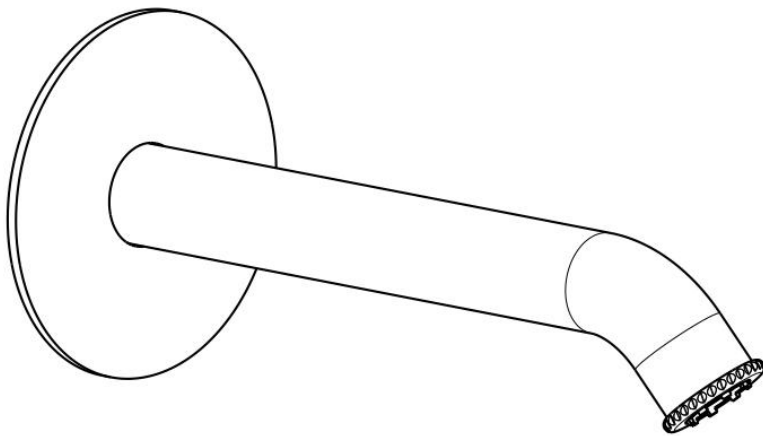

- **Single-person assembly**
- **Tools required**
- **We always recommend using professional tradespeople to install your product**

V1\_10.06.2025

# Congratulations on your purchase

*And welcome to our growing gang of savvy shoppers*

We're on a mission to bring you extraordinary bathroom products, for less. From modern to traditional style ceramics, plus the gorgeous fixtures, fittings and furniture to match. So, you can fall in love with your space every single day.

As one of the UK's largest independent bathroom stores, we've received countless awards; including the National Business Awards UK, the Digital Entrepreneur Awards and being placed on The Sunday Times Fast Track 100.

We hope your new product goes above and beyond your expectations. However, should any problems occur, please:

- log in to your account and contact our customer services team via your self-serve portal – [betterbathrooms.com/CustomerAccount/Login](https://betterbathrooms.com/CustomerAccount/Login)
- contact us via [betterbathrooms.com/content/contact-us](https://betterbathrooms.com/content/contact-us)

## Important information

- Please read these instructions thoroughly and retain for future reference
- Pressures should meet minimum stated on the website
- Pressures must be balanced for optimum performance
- Always check for pipes and cables before drilling

# Contents

1.Back plate( O-ring included )

2.Spout

3.Aerator key

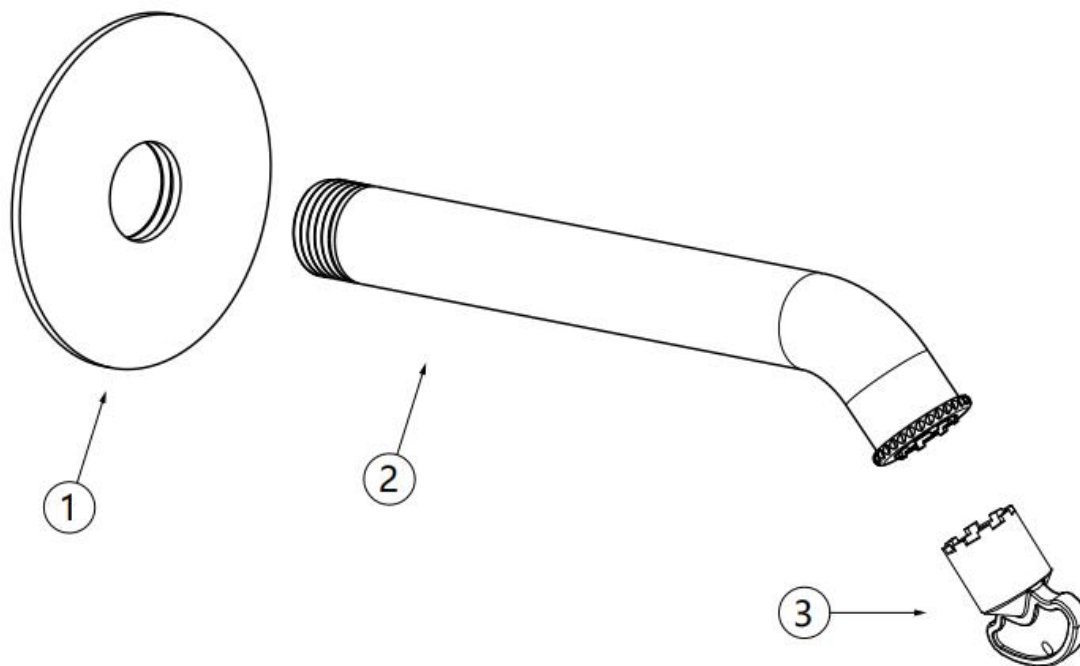

## Parts / Diagrams

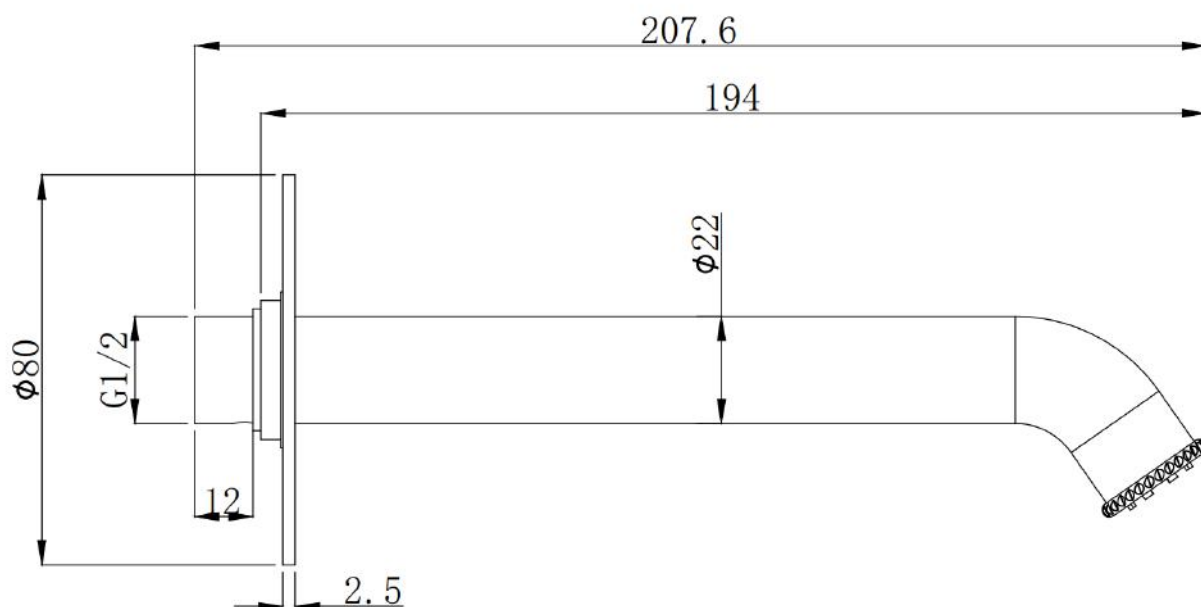

## Tools required

Installation requires a screwdriver, an adjustable wrench and adjustable pliers, silicone ,PTFE tape.

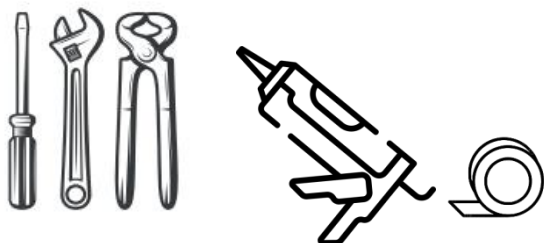

# Installation

**Wall pipe connector/elbow should be installed inside the wall (not supplied)**

1. Apply the PTFE sealing tape to the thread of the spout.

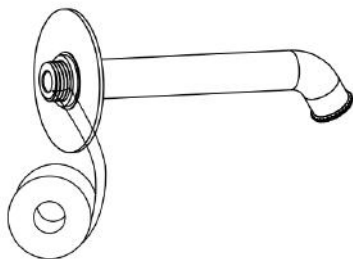

2. Twist the spout clockwise on and hand tighten.

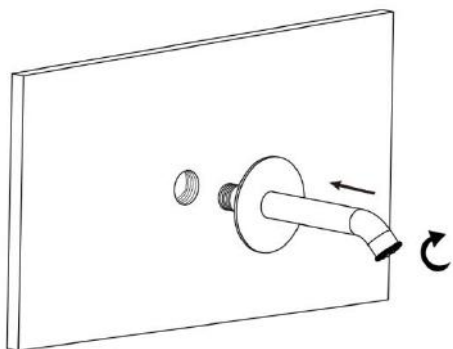

3. Push back plate to the wall surface. Ensure o-ring is firmly gripping the spout and creating a tight seal. Use silicone to seal the back plate.

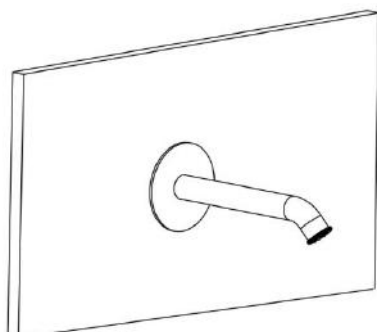

## Maintenance

1. Turn Off Water Supply.
2. Turn anticlockwise to loosen the aerator.
3. Install the new aerator clockwise .

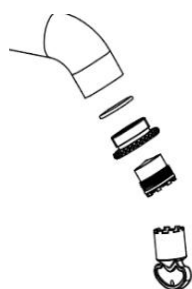

## Cleaning

Clean the product surface with a soft cloth and a mild detergent or citric acid solution. The use of any rough materials, as well as corrosive or abrasive cleaning agents, is not recommended as they may cause damage to the coating.

### ***For more information***

- visit [betterbathrooms.com](http://betterbathrooms.com)
- email [customerservices@buyitdirect.co.uk](mailto:customerservices@buyitdirect.co.uk)
- call 0330 390 3062
- write to Trident Business Park, Neptune Way, Huddersfield, HD2 1UA

**better  
bathrooms**

Part of the BuyItDirect Group